





THIS DOCUMENT IS  
 RELEASED FOR THE  
 PURPOSE OF INTERIM  
 REVIEW UNDER THE  
 AUTHORITY OF  
 JAMES B. BEERS,  
 TX R.A. 26854  
 IT IS NOT TO BE USED FOR  
 CONSTRUCTION PURPOSES.

TDLR # EABPRJB9800429

**AMERICAN LEGION SENIOR CENTER**  
 NOT FOR CONSTRUCTION  
 629 CALKINS STREET  
 DENTON, TEXAS  
 PROJECT MANAGER : JASON BENNETT  
 EMAIL : j.bennett@eikoncg.com

Issue Date: 02-06-2019  
 Project No: 17190

Drawn By: SLH  
 Checked By: JBB  
 Designed By: JBB

Revision Schedule		
#	Description	Date

ISSUED FOR PERMIT

LIFE SAFETY

**G0.3**

**LIFE SAFETY PLAN LEGEND**

- ALL STORAGE SPACES ARE CONSIDERED S-1(Accessory) AND DO NOT HAVE RATING REQUIREMENTS.
- ASSEMBLY SPACES ARE IDENTIFIED ON THE LIFE SAFETY PLAN AS A-3(Accessory).

**LIFE SAFETY PLAN NOTES**

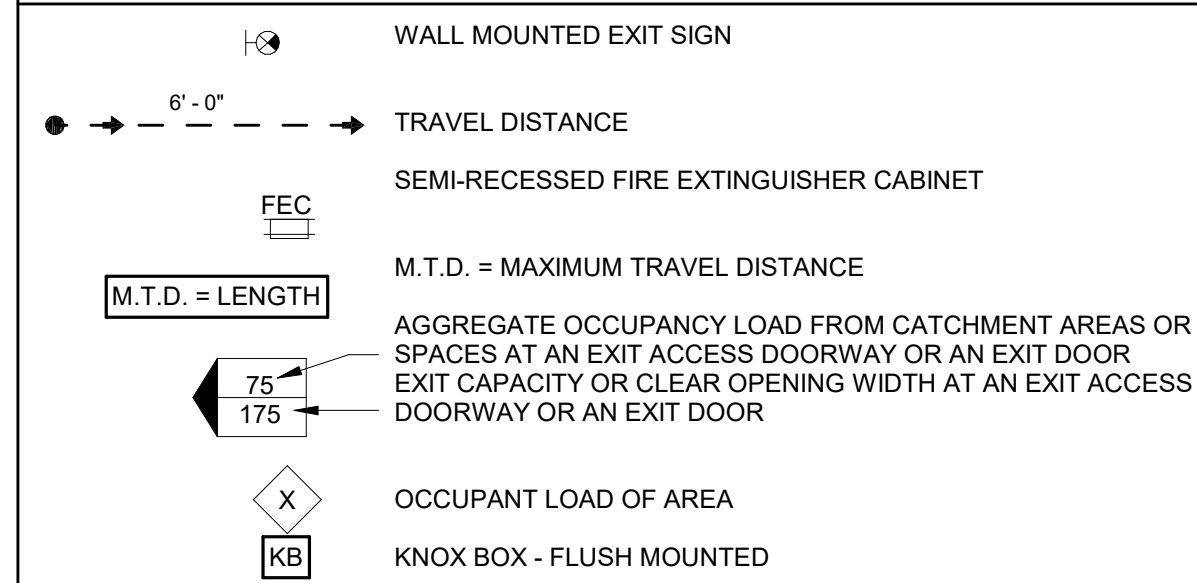

**OCCUPANCY TABULATION PER 2015 IBC TABLE 1004.1.2**

ROOM NAME	NUMBER	AREA	SQ FT PER OCCUPANT	OCCUPANT LOAD CALCULATED
LOGGIA	101	607 SF	100	7
MULTI-PURPOSE A	102	1315 SF	15	88
MULTI-PURPOSE B	103	1453 SF	15	97
AV/ ELEC.	104	92 SF	300	1
PANTRY	105	54 SF	300	1
WARMING KITCHEN	106	286 SF	200	2
STORAGE	107	215 SF	300	1
SPRINKLER ROOM	108	59 SF	0	1
CORRIDOR	109	581 SF	100	6
OFFICE	110	100 SF	100	1
RECEPTION	111	115 SF	100	2
COORIDOR	112	505 SF	100	1
STORAGE	113	82 SF	300	1
IT/ELEC.	114	53 SF	300	1
CLASSROOM	115	347 SF	20	18
REC ROOM AREA	116	225 SF	50	5
COMPUTER LAB	117	304 SF	20	16
FITNESS AREA	118	285 SF	50	6
WOMEN	119	173 SF	0	0
MEN	120	174 SF	0	0
JANITOR	121	44 SF	0	0
<b>OCCUPANCY TOTAL</b>				<b>253</b>

**EXIT SUMMARY - LEVEL 1**

EXIT TYPE	EXIT	EXIT FACTOR	WIDTH PROVIDED IN INCHES	CAPACITY IN PERSONS
EXIT	001	0.2	72"	360
EXIT	002	0.2	72"	360
EXIT	002	0.2	40"	200
EXIT	003	0.2	72"	360
EXIT	AAA	0.2	44"	220
EXIT	AAA	0.2	44"	220
EXIT	AAA	0.2	44"	220
EXIT	AAA	0.2	44"	220
EXIT	AAA	0.2	44"	220
EXIT	AAA	0.2	44"	220
EXIT	AAA	0.2	44"	220
<b>TOTAL EXIT CAPACITY</b>				<b>2820</b>

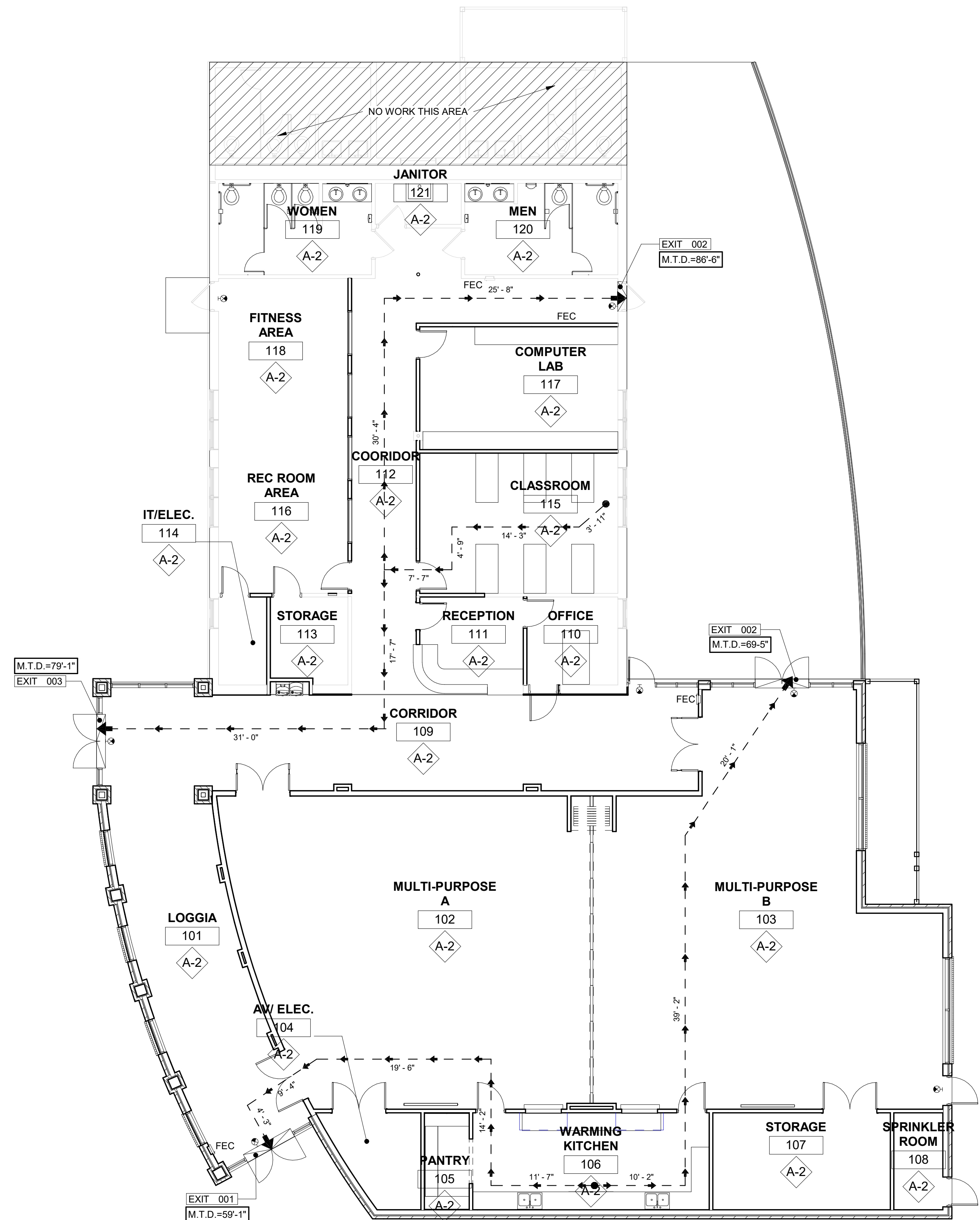

CONFIDENTIAL & PROPRIETARY ©2019 EIKON Consulting Group LLC. All rights reserved - do not duplicate without permission



